

18	E161-00	SENSOR	1
17	11087-1	WASHER	2
16	82261100	SENSOR SCREW	2
15	E009-26-A	TOP PLATE ASSY	1
14	E009-31-A	BASE PLATE	1
13	E127-00	RETAINING RING	2
12	E008-7	SPINDLE PIVOT	1
11	82259400	DRIVE SPINDLE	1
10	E005-5	ROLLER ASSY	1
9	E004-11	SPRING SPACER	1
8	E004-10	ARBOR	1
7	99111281	OUTER SPRING	1
6	99111271	INNER SPRING	1
5	4032-513-000	SPRING - PIVOT	1
4	4-8005	WASHER	1
3	4-8004	WASHER	1
2	4-8002	NYLINER BEARING (GREY)	1
1	4-8001	NYLINER BEARING (WHITE)	4
ITEM	PART NO.	DESCRIPTION	REQ'D

- NOTES:
- PEDAL TO MEET CUMMINS 2007 ENGINE REQUIREMENTS AS DEFINED IN CUMMINS ENGINE STANDARD I4616 AND AEB15.67.
 REQUIREMENTS FOR APS1
 a. CLOSED THROTTLE GREATER THAN 19% OF REF. VOLTAGE
 b. WIDE OPEN THROTTLE LESS THAN 87% OF REF. VOLTAGE
 c. SPAN GREATER THAN 57% OF REF. VOLTAGE
 REQUIREMENTS FOR APS2
 a. CLOSED THROTTLE GREATER THAN 8% OF REF. VOLTAGE
 b. WIDE OPEN THROTTLE LESS THAN 45% OF REF. VOLTAGE
 c. SPAN GREATER THAN 26% OF REF. VOLTAGE
 - ELECTRICAL CONNECTOR [6 PIN] DELPHI / PACKARD
 SUGGESTED MATING PARTS:
 CONNECTOR 12066317
 TERMINAL 12110236 OR EQUIVALENT.
 - TORQUE SENSOR SCREWS (82261100) TO 23±5 IN-LBS
 APPLY TAMPERPROOF COMPOUND

WIRING TABLE	
"A"	APS1 - SIGNAL
"B"	APS1 - GROUND
"C"	APS1 - SUPPLY
"D"	APS2 - SUPPLY
"E"	APS2 - GROUND
"F"	APS2 - SIGNAL

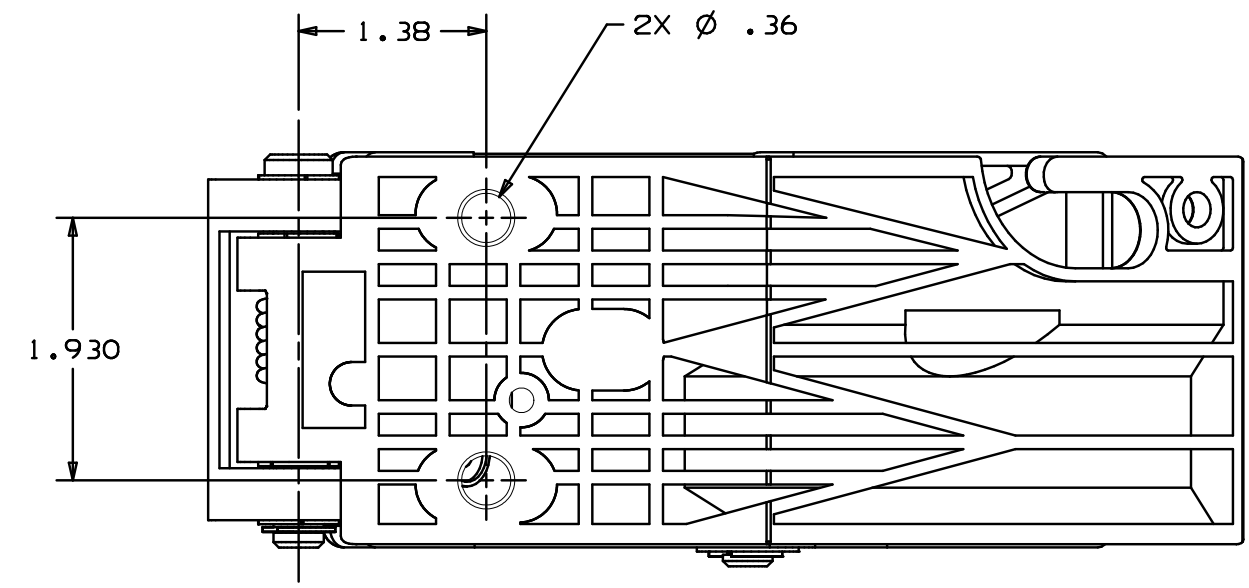

PROPRIETARY NOTICE: DO NOT COPY THIS DOCUMENT AND ALL DATA CONTAINED HEREIN ARE PROPRIETARY INFORMATION OF ORSCHELN. ANY REPRODUCTION OR DISTRIBUTION OF THIS DOCUMENT WITHOUT THE WRITTEN PERMISSION OF ORSCHELN IS STRICTLY PROHIBITED. THIS DOCUMENT IS THE PROPERTY OF ORSCHELN AND IS TO BE USED ONLY FOR APPROVED PURPOSES.

13998	060110	--	ORIGINATED DRAWING (62198800)	CA/	SB
ECN	DATE	REV	REVISION	DR	CK
MATERIAL: ---			TREATMENT/FINISH: ---		
MOBERLY, MO CAGE CODE: 92867		DO NOT SCALE THIRD ANGLE PROJECTION		DR CASBURY	CHK DATE 060110
UNLESS OTHERWISE SPECIFIED SCALE: NTS ANG ± 3° .XX ± .03 .XXX ± .015		THROTTLE ASSY			
ORSCHELN		PART NO. EFP136-01			